



Parking Instructions

Main Office Location: 36 South State Street, Suite 1400, Salt Lake City

Validated parking for guests of the firm is available in the Key Bank Tower Parking Garage.

You may use one of two entrances:

- (1) **On State Street, between South Temple and 100 South:** You must be traveling south on State Street in order to access the ramp, which is on the west side of the road. Once you have taken a parking ticket, proceed to the Customer Parking area. You will be on the City Creek East P1 parking level. Make your way to one of the elevators or the escalator (indicated in red on the map). Take the elevator/escalator up to City Creek Center Level 2. From here you will walk east across the bridge and head toward the south doors to the Key Bank Tower.
- (2) **On 100 South, between State Street and Main Street:** You must be traveling west on 100 South in order to access the ramp. Once you have taken a parking ticket, proceed to the Customer Parking area. You will be on the City Creek East P2 parking level. Make your way to one of the elevators or the escalator (indicated in red on the map). Take the elevator/escalator up to City Creek Center Level 2. From here you will walk east across the bridge and head toward the south doors to the Key Bank Tower.

Follow the signs that lead to the elevators to the Food Court and Key Bank Tower. Take the elevator up to the Food Court Level. Walk a few steps into the Food Court and proceed past Sbarro and Roxberry. Continue walking left past Subway to a set of glass doors. Take the elevator inside these doors to Level L, which will lead to the Lobby of the Key Bank Tower.

Once you are in the Key Bank Tower Lobby, make your way to the eastern set of elevators marked Floors 7-16. On the outside of the elevators are key pads on which you will punch in the number of the floor you want to go to (Floor 14 for Ray Quinney & Nebeker). From here the keypad will indicate which elevator car you should get into (A, B, C or D). Once the elevator door opens for your designated car, you may proceed, and the car will stop on the 14th Floor where you will find our main reception area.

If you have any questions, please call our front desk at (801) 532-1500.

Scan with your Smart Phone for directions to our office >>



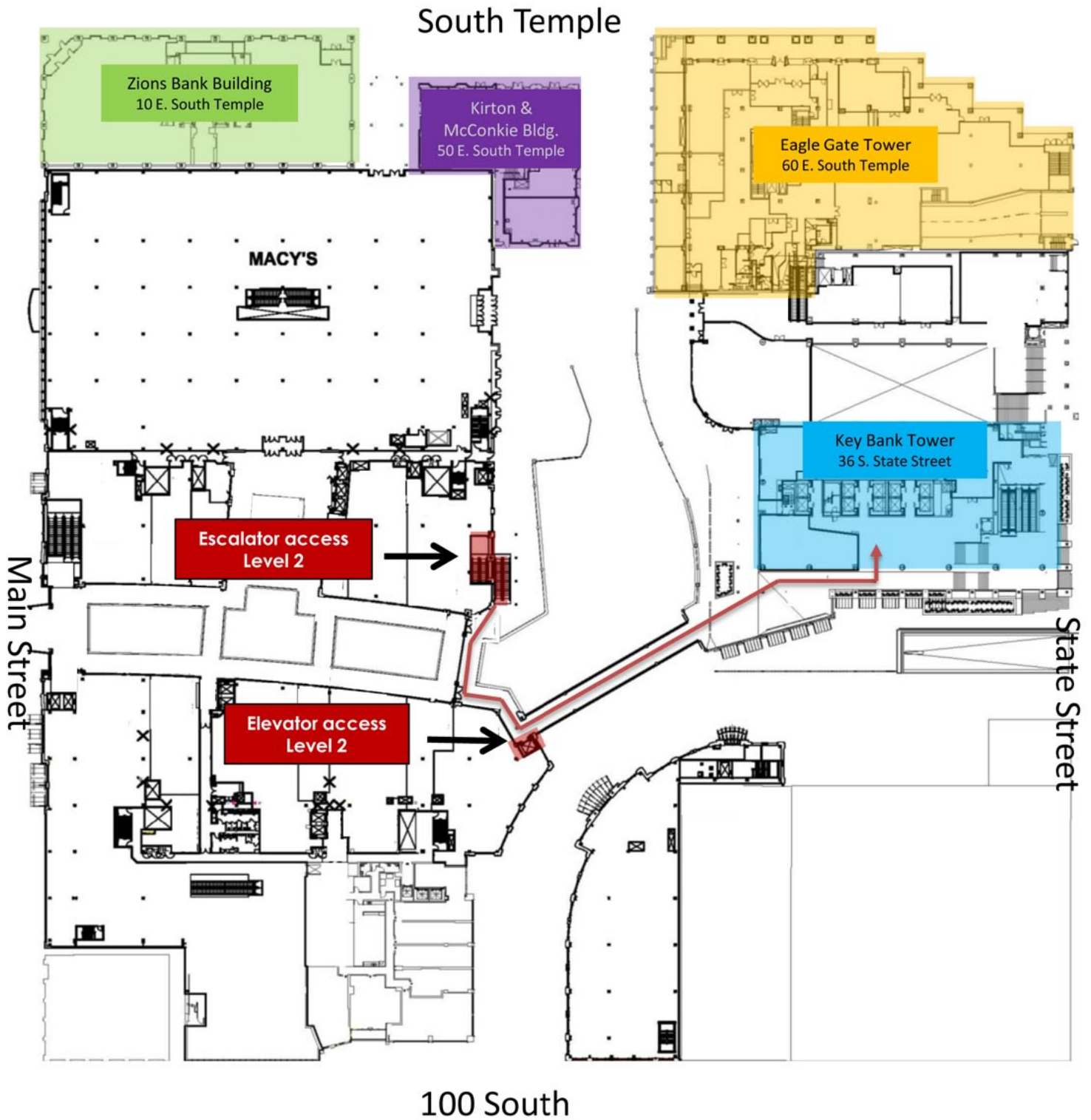

**KEY BANK TOWER
VISITOR PARKING**

